

Bronze Y-Strainer

PN20

Size ½" to 2" only

Specifications:

IVAL® Bronze Y-Strainer, with body and bonnet to (EN1982 CC491K), PTFE gasket, Threaded Ends, PN20 rating.

Stainless Steel Mesh.

UK END CONNECTION: BSPT Taper Threaded to BS EN 10226-1, compatible with ISO 7/1.

WRAS approved.

Features:

- Eliminate the problems caused by foreign matter within piping systems.
- Perforated stainless steel screen with robust design.
- Robust and high-quality bronze body.
- Streamlined flow contours minimize pressure drop.
- Compact design with short face to face.
- Perforated stainless steel screen.
- Captive asbestos-free non-stick PTFE gasket
- Rated 2.0 MPa.

Pressure/Temperature Ratings:

Temperature (°C)	-10 to +100	180
Pressure (Bar)	20	9

Intermediate pressure ratings shall be determined by interpolation.

Materials:

No.	Description	Material	Specification
1	Body	Bronze	EN 1982 CC491K
2	Bonnet	Bronze	EN 1982 CC491K
3	Strainer	Stainless Steel	AISI 304
4	Gasket	PTFE	-
5	Nameplate	L2	-
6	Rivet	Stainless Steel	AISI 304

Dimensions:

Size	DN15	DN20	DN25	DN32	DN40	DN50
Thread A	½"	¾"	1"	1 ¼"	1 ½"	2"
L (mm)	57	72	74.5	95	105	129
H (mm)	34	39.5	43	54	61.5	74.5
D (mm)	15	18.5	21	29	32	46
E (mm)	11.5	14	16	18	18	21
Mesh Thick	0.6 mm			0.4 mm		
Mesh Hole	Ø 0.6 mm			Ø 1 mm		
Weight (g)	191	285	397	697	930	1,359

TECHNICAL DATASHEET

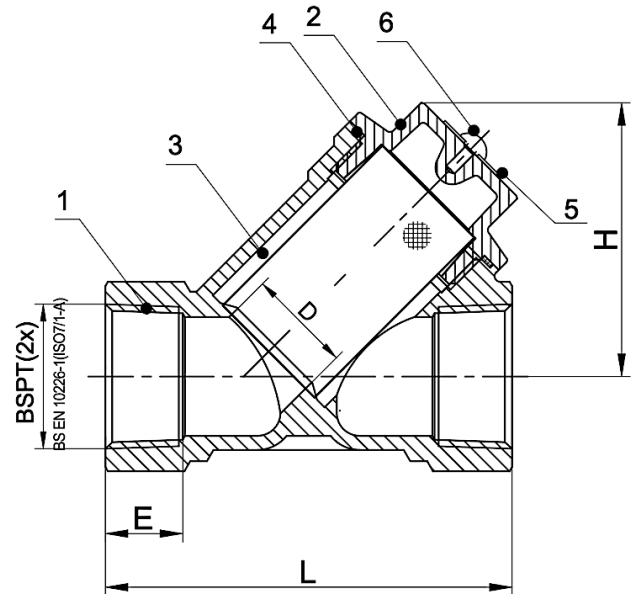

This valve is not suitable for use on Gases Group 1 & 2 or unstable fluids Group 1, as defined by the Pressure Equipment Directive 2014/68/EU.



Flow Characteristics:

Size	DN15 - 1/2"	DN20 - 3/4"	DN25 - 1"	DN32 - 1.1/4"	DN40 - 1.1/2"	DN50 - 2"
Kv (m3/h)	4.61	8.51	9.85	17.05	20.28	39.22

Formula linking flow **Q (in l/s)** and theoretical valve head loss **ΔP (in KPa)**:

$$\Delta P = \left(\frac{36 \cdot Q}{K_v} \right)^2$$

Pressure Loss vs. Flow Rate Chart:

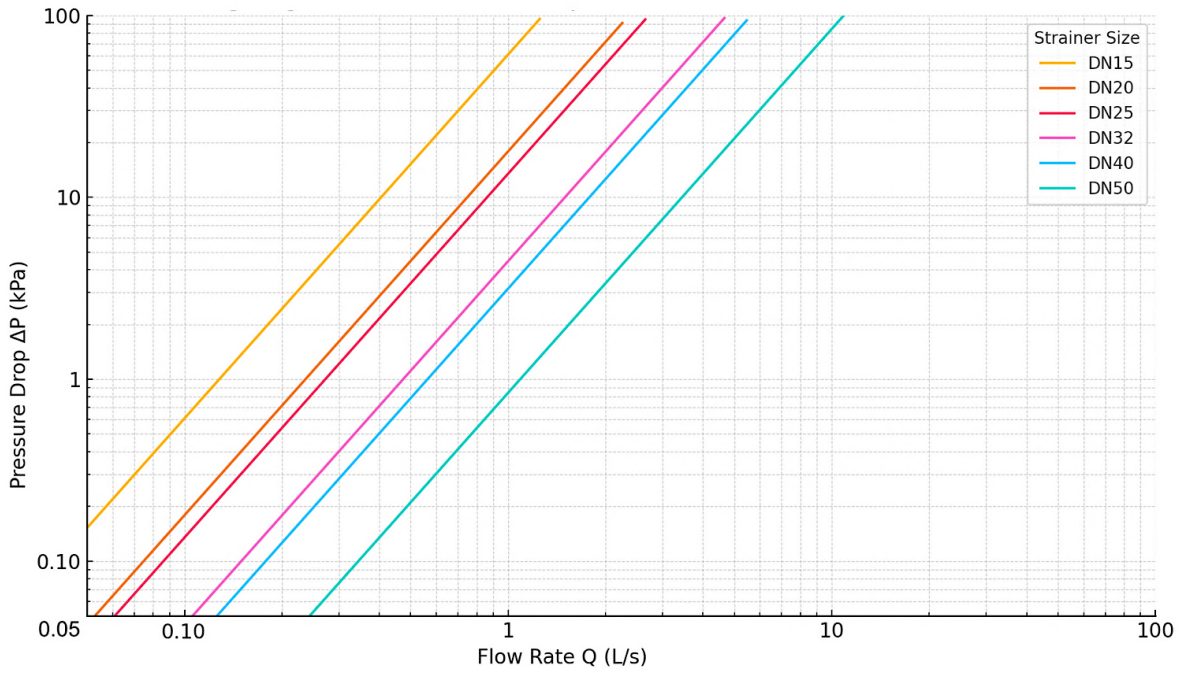

Drawings, photos and data contained in this document are provided for information only. IVAL reserves the right to change them without notice.

